

# Delaware River

John T. Fassnacht  
 D31 Stream Rehabilitation  
 Atchison County, Kansas  
 NE 1/4, SEC 29, T6S, R17E

**Sheet Index**

Sheet No.	Sheet Title
1	Cover Sheet
2	General Layout
3-5	Section Views
6	Details



Atchison County Map

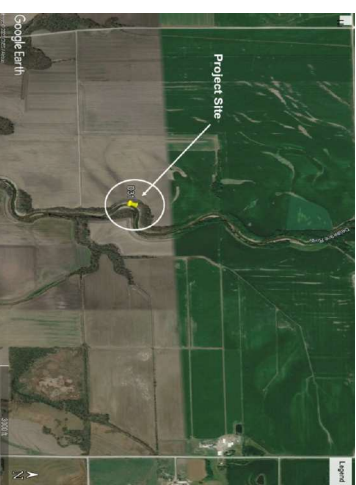

Site Location Map  
 NTS



**Quantities**

Round Logs	65
Round Logs	105
Rock/T Logs 24 in. D50	484
SPM (round) Culp's Yds. *	6,087
Bare Rock Tons	894
Log Spikes	4,972
Log Spikes Spacing / acres	1.7
Matting / acres	1.18



Not For Construction Without a  
 Professional Engineer Seal.

Date	7/26/23	Comment	
Designed By:	RG	No.	1
Checked By:	DWG	BY	CK
Date:	7/26/23	Scale:	1"=40'



Delaware River  
Site 37  
Atchison County, Kansas

Overall Plan View

2 of 6



- GENERAL NOTES**
- Before any construction activity, the contractor is responsible for obtaining all applicable permits for all disturbed areas by the Contractor.
  - Accepted Erosion Control practices shall be applied to all project construction.
  - All applicable permits will be obtained by others prior to project construction.
  - The information shown in these plans concerning type and location of underground utilities is not guaranteed to be accurate or all inclusive. Existing utilities and their locations, as shown on the plans, represent the best information obtained for the design. Construction companies and is either from company record drawings or company provided field locations. The utility locations shown are not guaranteed. Additional existing utilities for making the determinations as to the type and location of underground utilities as may be necessary to avoid damage thereto. Contractor shall coordinate with utility companies as necessary for relocation and protection of utilities.
  - Contractor shall maintain construction limits within the existing and/or proposed rights-of-way and easements.
  - The engineer has not performed property or right-of-way surveys for any of the locations shown on this project. Right-of-way or property lines shown on the plans are approximate and are shown for survey markers have not been located, unless specifically called out on the plans.
  - Coordinates for this project are not associated to any known coordinate system and are local only.
  - Do not remove any trees larger than 12" DBH or over 50' in height without permission of the Engineer.
  - Soil mooring calculations are based on available information. Contractor shall inspect the site and make an evaluation of existing conditions.
  - Contractor is responsible for planting from top of LESP or water level to top of bank.
- LEGEND**
- Existing Edge of Water
  - Existing Top of Bank
  - Existing 1' Contour
  - Existing 5' Contour
  - Proposed 1' Contour
  - New Improvements
- BENCHMARKS**
- |      |                |                 |               |
|------|----------------|-----------------|---------------|
| BM-1 | Sta. -14470.42 | N 1435270.9813  | E 924533.4210 |
| BM-2 | Sta. -14470.42 | N 1435189.7636  | E 924846.4735 |
| BM-3 | Sta. -14470.42 | N 1435264.48100 | E 924533.4210 |
- Rootwoods  
Begin Sta. 0+15, 233' L.L.  
End Sta. 8+27, 194' L.L.  
680' Long

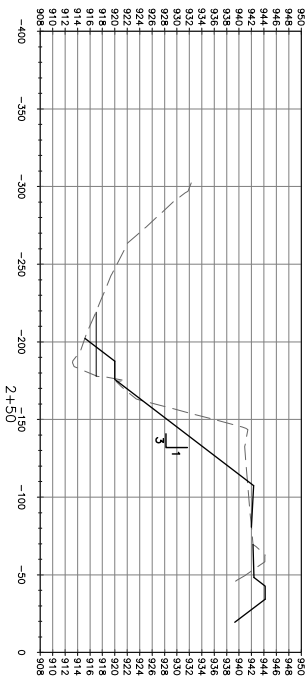
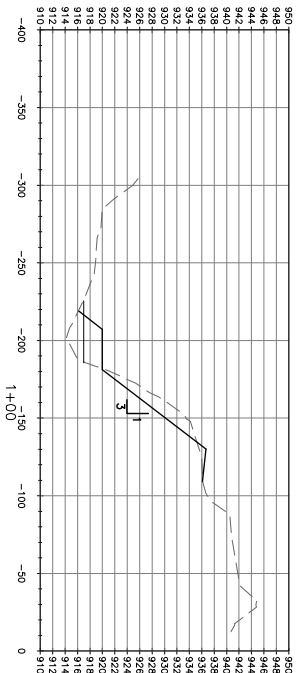
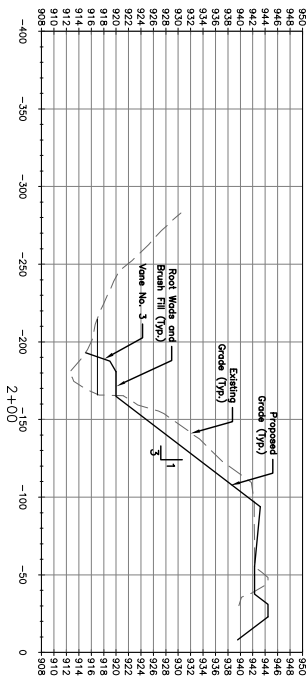
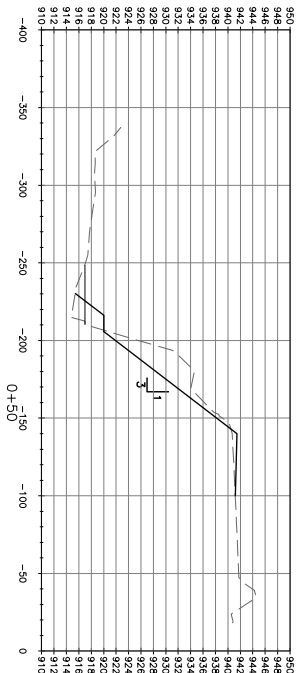
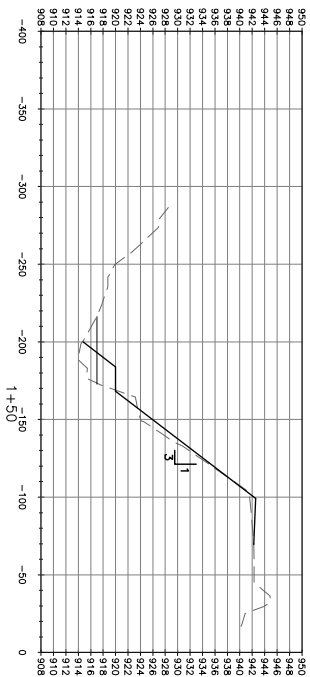
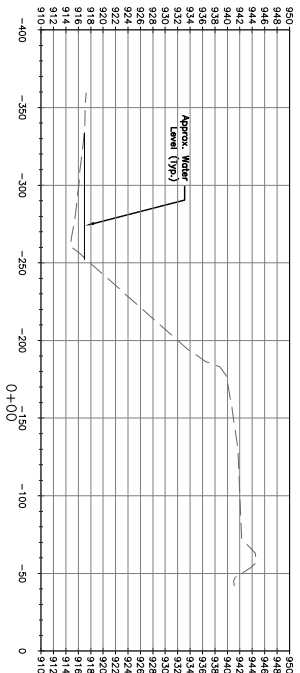

Note:  
All slopes steeper than 3:1 require Excelsior Blanket on disturbed slopes.

Not For Construction Without a Professional Engineer Seal.

Scale:  
Horiz.: 1"=40'  
Vert.: 1"=10'

Date	7/29/23	Comment	1
Designed By:	RGH		2
Checked By:	DWB		3
Date:	7/29/23		4
Scale:	1"=40'		



**Delaware River**  
Site #7  
Atchison County, Kansas

Sections Sheet 1 of 6

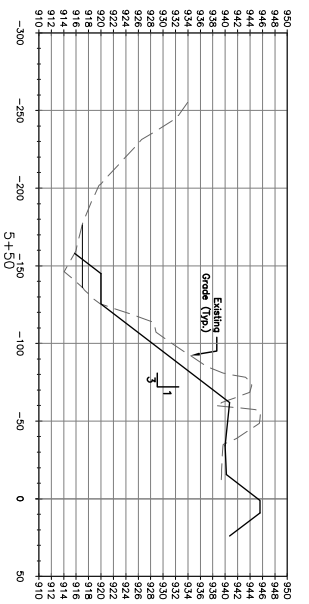
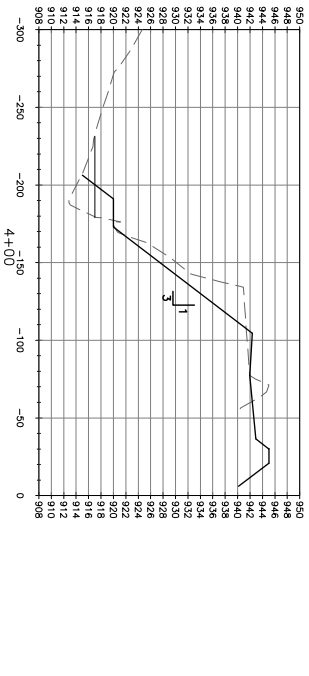
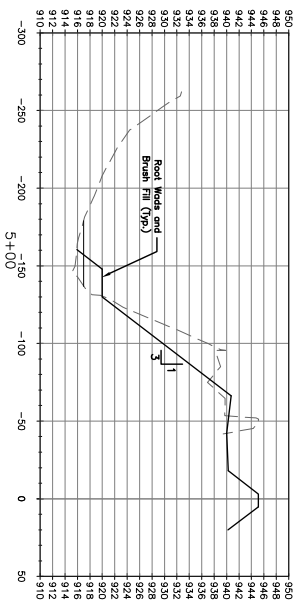
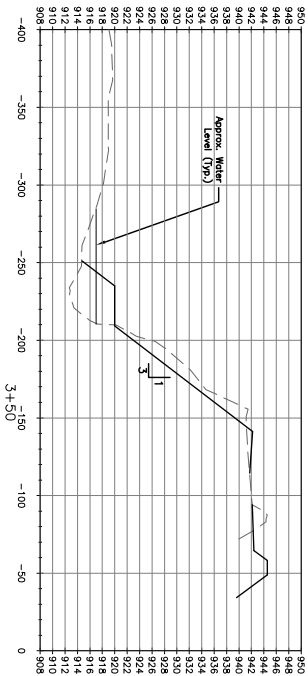
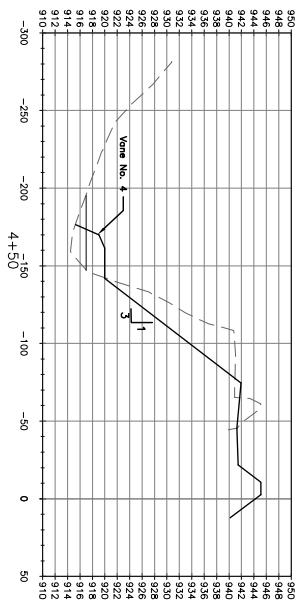
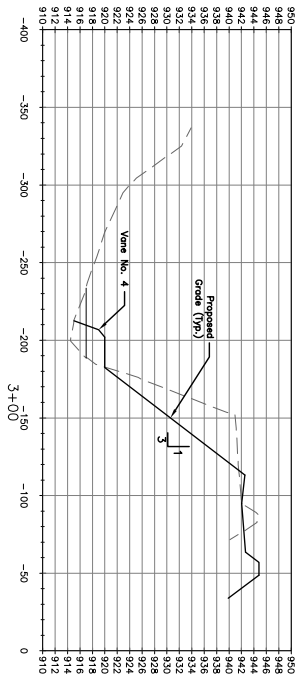

Note:  
 All slopes steeper than  
 3:1 require Excelsior  
 Blanket on disturbed  
 slopes.  
 Not For Construction  
 Without a Professional  
 Engineer Seal.

Scale:  
 Horiz.: 1"=40'  
 Vert.: 1"=10'

Date	Comment	No.	BY	CK	APP
		1			
		2			
		3			

Designed By: RGR  
 Checked By: DWB  
 Date: 7/29/23  
 Scale: 1"=40'



Delaware River  
 Site 37  
 Atchison County, Kansas  
 Sections Sheet 2  
 4 SHEET OF 6



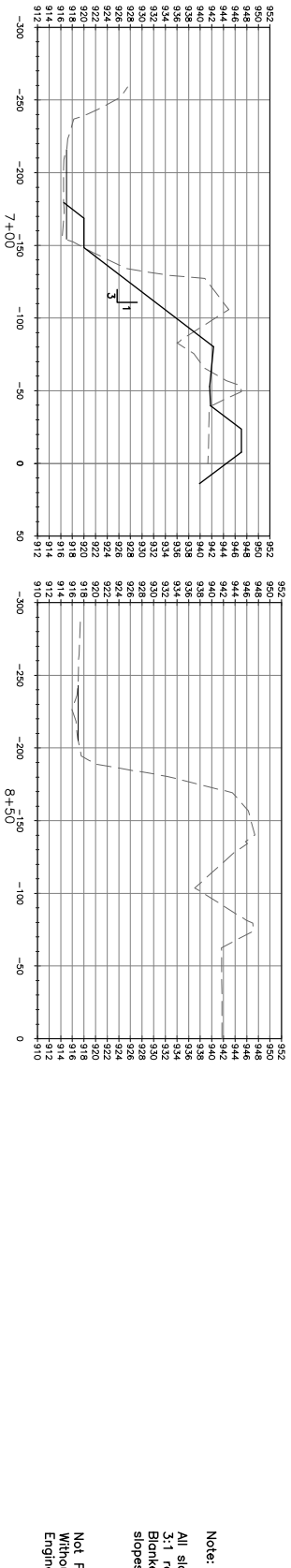
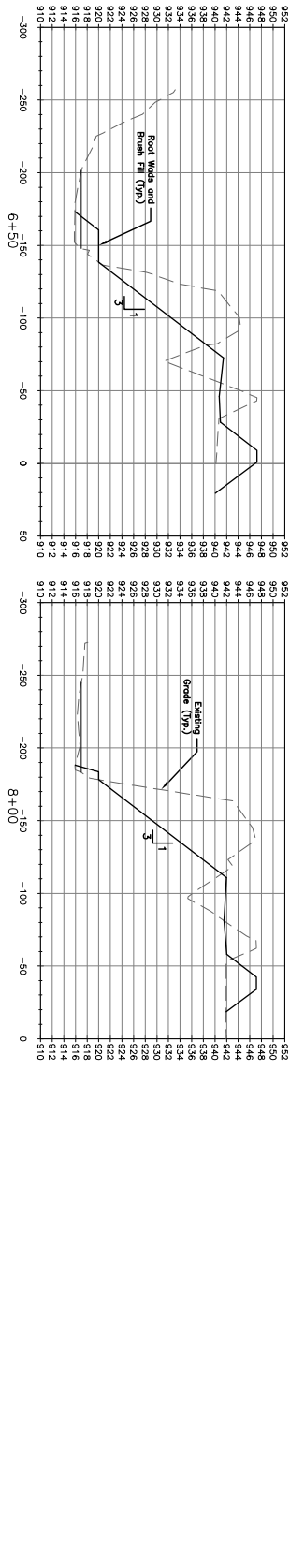
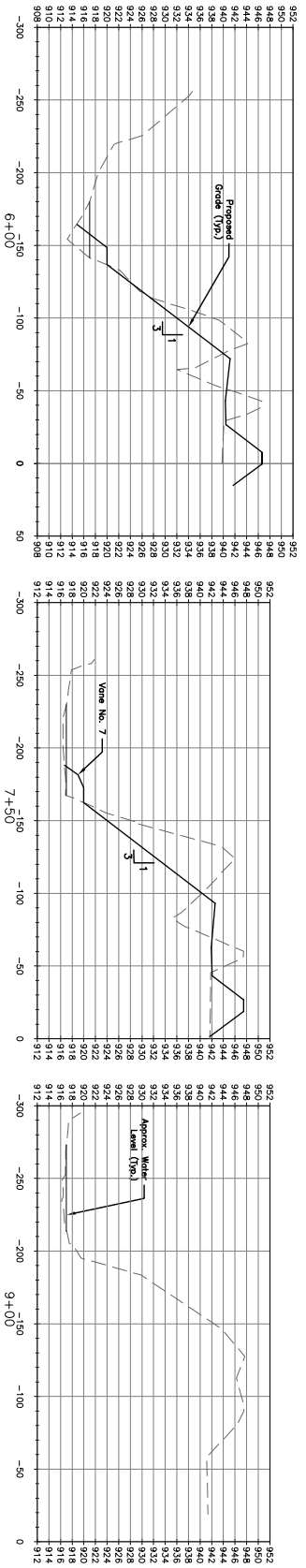

No.	BY	CHK	APP
1			
2			
3			
4			

Date	Comment
7/26/23	Design By: RGR
	Checked By: DWB
	Date: 7/26/23
	Scale: 1"=40'

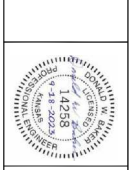

**Delaware River**  
 Site 37  
 Atchison County, Kansas

**Sections Sheet 3**

Scale:  
 Horiz.: 1"=40'  
 Vert.: 1"=10'

5 of 6

**Note:**  
 All slopes steeper than 3:1 require Excelsior Blanket on disturbed slopes.  
 Not For Construction Without a Professional Engineer Seal.

